

K30-TYPE

Planetary GEARHEAD

DIMENSIONS

K30-2847 SERIES

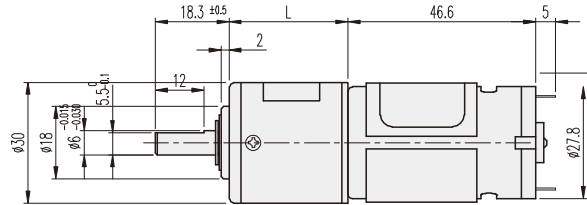
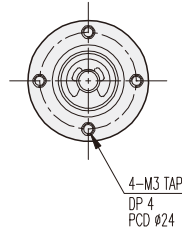

GEARHEAD LENGTH

RATIO	L
1/005	23.1
1/014 ~ 1/027	29.5
1/051 ~ 1/139	35.9
1/189 ~ 1/721	42.3

MOTOR PERFORMANCE DATA

MODEL	ITEM	VOLTAGE (DC)	NO LOAD		AT MAX. EFF.			STALL		WEIGHT (g)
			mA	rpm	gf-cm	A	rpm	A	gf-cm	
KD2847T1		12V	170	7300	90	0.65	6300	5	830	110
KD2847T2		24V	90	7300	110	0.4	6300	2.8	870	

AT MAXIMUM EFFICIENCY (K30-□□□□-KD2847T□)

GEAR	MODEL	KD2847T1		KD2847T2	
		DC 12V		DC 24V	
		rpm	kgf-cm	rpm	kgf-cm
1/0005		1260	0.4	1260	0.5
1/0014		450	1	450	1.2
1/0019		331	1.3	331	1.6
1/0027		233	1.9	233	2.4
1/0051		123	3	123	4
1/0071		88	4.5	88	5.5
1/0100		63	6.5	63	8
1/0139		45	9	45	11
1/0189		33	11	33	12
1/0264		23	12	23	12
1/0369		17	12	17	12
1/0516		12	12	12	12
1/0721		8.7	12	8.7	12

* 減速比整個電動機和輸出軸的旋轉方向相同。